

## Sae J518 Code 61 Flange Dimensions

### SAE J518 CODE 61 FLANGE DIMENSIONS

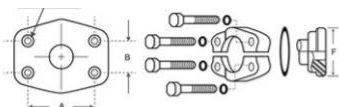

Dash	Port Size	Bolt Size	Recommended Code 61 Working Pressure		Bolt Spacing "A" +/- 0.010		Bolt Spacing "B" +/- 0.010		Flange O.D. "F" +/- 0.010	
			PSI	MPa	MM	In.	MM	In.	MM	In.
-06	1/2"	5/16-18 x 1 1/4"	5,000	34.5	38.1	1.50	17.5	0.69	30.2	1.19
-10	5/8	M8-1.25 x 30mm	5,000	34.5	42.9	1.69	19.8	0.78	34.0	1.34
-12	3/4	3/8-16 x 1 1/4	5,000	34.5	47.6	1.88	22.4	0.88	38.1	1.50
-16	1	3/8-16 x 1 1/4	5,000	34.5	52.4	2.06	26.2	1.03	44.4	1.75
-20	1 1/4	7/16-14 x 1 1/2	4,000	27.6	58.7	2.31	30.2	1.19	50.8	2.00
-24	1 1/2	1/2-13 x 1 1/2	3,000	20.7	69.8	2.75	35.8	1.41	60.3	2.38
-32	2	1/2-13 x 1 3/4	3,000	20.7	77.8	3.06	42.9	1.69	71.4	2.81
-40	2 1/2	1/2-13 x 1 3/4	2,500	17.2	88.9	3.50	50.8	2.00	84.1	3.31
-48	3	5/8-11 x 3/4	2,000	13.8	106.4	4.19	62.0	2.44	101.6	4.00

### SAE J518 CODE 61 FLANGE INDUSTRIES AND APPLICATIONS

WIDELY USED IN THE INDUSTRIES

- Pumps, Valves, and vessels in manufacturing and food processing.
- Pipe connections in industrial waterworks.
- Heat exchangers and heating systems of all sizes.
- Mining support.
- Nuclear power systems.
- Plumbing and mechanical systems.
- Assemblies in the oil, gas, and petrochemical industries.
- Fire protection systems.