

SABS 1123 Class 4000 Welding On Flange

SABS 1123 CLASS 4000 WELDING ON FLANGE DIMENSIONS, WEIGHT, AND TECHNICAL DRAWING

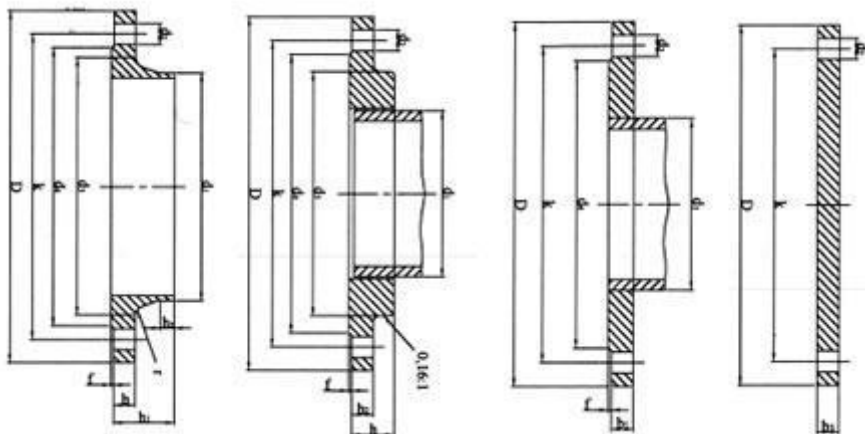

SABS 1123 CLASS 4000 WELDING ON FLANGE DIMENSIONS & APPROXIMATE MASSES

Nominal pressure 4000 kPa		4000/2 = Table 24				4000/4 = Table 26		4000/3 = Table 25		400						
Table 28																
NB	Pipe O.D. d1	Flange							Raised Face		Bolt	Drilling			Neck	
		D	b	b1	b2	b3	h	h1	d4	f		No.	d2	k	d3	h2
10	17.2	90	12	12	12	12	18	35	40	2	M12	4	14	60	28	6
15	21.3	95	14	14	14	14	20	38	45	2	M12	4	14	65	32	6

* T4000/2=Welding Neck Flange, T4000/3=Slip on FF Flange, T4000/4=Threaded Screwed Flang
T4000/5= Slip on Bossed Flange, T4000/8=Blind Flange

* NP = Nominal Pressure 600kPa, 1000kPa, 1600kPa, 2500kPa, 4000kPa

SABS 1123 CLASS 4000 WELDING ON FLANGE INDUSTRIES AND APPLICATIONS

WIDELY USED IN THE INDUSTRIES

- Pumps, Valves, and vessels in manufacturing and food processing.
- Pipe connections in industrial waterworks.
- Heat exchangers and heating systems of all sizes.
- Mining support.
- Nuclear power systems.
- Plumbing and mechanical systems.
- Assemblies in the oil, gas, and petrochemical industries.
- Fire protection systems.

marcelforged.com