

SABS 1123 Class 2500 Welding On Flange

SABS 1123 CLASS 2500 WELDING ON FLANGE DIMENSIONS, WEIGHT, AND TECHNICAL DRAWING

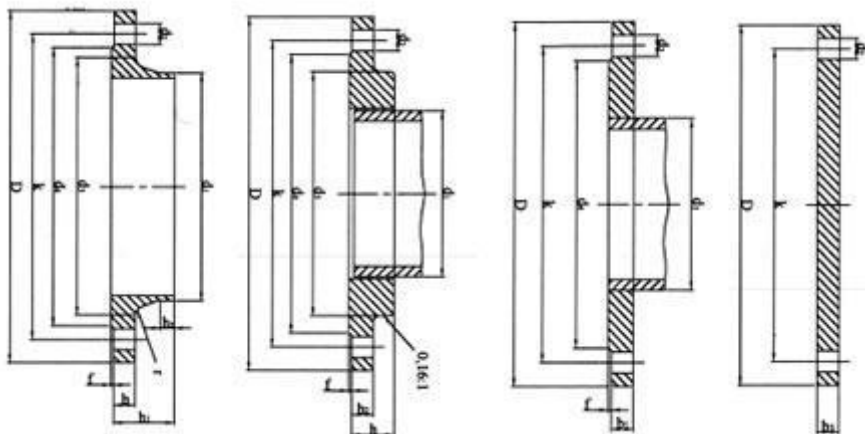

SABS 1123 CLASS 2500 WELDING ON FLANGE DIMENSIONS
FLANGE DIMENSIONS & APPROXIMATE MASSES

Nominal pressure 2500 kPa		2500/2 = Table 19			2500/4 = Table 21			2500/3 = Table 20			25					
Table 23																
NB	Pipe O.D. d1	Flange							Raised Face		Bolt	Drilling			Neck	
		D	b	b1	b2	b3	h	h1	d4	f		No.	d2	k	d3	h2
10	17.2	90	12	12	10	12	16	35	40	2	M12	4	14	60	28	6
15	21.3	95	14	14	11	14	17	38	45	2	M12	4	14	65	32	6

20	26.9	105	14	14	11	14	19	40	58	2	M12	4	14	75	40	6
25	33.7	115	16	16	12	16	22	40	68	2	M12	4	14	85	46	6
32	42.4	140	18	18	14	18	26	42	78	2	M16	4	18	100	55	6
40	48.3	150	18	20	14	20	28	45	88	3	M16	4	18	110	64	7
50	60.3	165	20	20	17	20	31	48	102	3	M16	4	18	125	75	8
65	76.1	185	22	22	17	22	33	52	122	3	M16	8	18	145	90	10
80	88.9	200	24	22	18	22	34	58	138	3	M16	8	18	160	105	12
100	114.3	235	24	25	21	25	41	65	162	3	M20	8	22	190	134	12
*125	139.7	270	26	28	24	28	46	68	188	3	M24	8	26	220	162	12
150	168.3	300	28	30	24	30	48	75	218	3	M24	8	26	250	192	12
*175	193.7	330	30	30	-	25	-	75	248	3	M24	12	26	280	218	15
200	219.1	360	30	30	-	30	-	80	278	3	M24	12	26	310	244	16
*225	244.5	395	30	30	-	30	-	84	306	3	M24	12	26	340	270	16
250	273.0	425	30	30	-	30	-	88	335	3	M24	12	26	370	298	18
300	323.9	485	34	32	-	32	-	92	395	4	M24	16	26	430	352	18
350	355.6	555	38	35	-	35	-	100	450	4	M30	16	33	490	398	20
400	406.5	620	40	40	-	40	-	110	505	4	M30	16	33	550	452	20
450	457.2	670	42	45	-	45	-	110	555	4	M30	20	33	600	505	20
500	508.0	730	44	50	-	50	-	125	615	4	M30	20	33	660	558	20
550	559.0	785	-	55	-	-	-	-	670	5	M36	20	39	710	-	-
600	609.6	845	46	60	-	-	-	125	720	5	M36	20	39	770	660	20

* T2500/2=Welding Neck Flange, T2500/3=Slip on FF Flange, T2500/4=Threaded Screwed Flang
T2500/5= Slip on Bossed Flange, T2500/8=Blind Flange

* NP = Nominal Pressure 600kPa, 1000kPa, 1600kPa, 2500kPa, 4000kPa

SABS 1123 CLASS 2500 WELDING ON FLANGE INDUSTRIES AND APPLICATIONS

WIDELY USED IN THE INDUSTRIES

- Pumps, Valves, and vessels in manufacturing and food processing.
- Pipe connections in industrial waterworks.
- Heat exchangers and heating systems of all sizes.
- Mining support.
- Nuclear power systems.
- Plumbing and mechanical systems.
- Assemblies in the oil, gas, and petrochemical industries.
- Fire protection systems.

marcelforged.com