

## MSS SP 44 Class 400 Flanges Dimensions

### MSS SP 44 CLASS 400 FLANGES DIMENSIONS

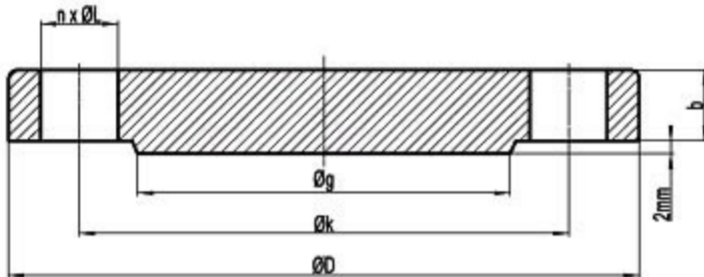

Series A Class 400 Flanges Dimensions										
Normal Size	Outside Daimeter	Thick.		Outside Daimeter of RF	Diameter at Base	Bore	LTH	Drilling		
		WN	BLRF					Diameter Bevel	Circle Of Bolt	Lengt Of Bol
O	C	C	R	X	B	Y	A	1	2	
26	38.25	3.5	3.88	29.5	28.62	-	7.62	26	34.5	12.5
28	40.75	3.75	4.12	31.5	30.81		8.12	28	37	13.25
30	43	4	4.38	33.75	32.94		8.62	30	39.25	14
32	45.25	4.25	4.56	36	35		9.12	32	41.5	14.25

34	47.5	4.38	4.81	38	37.19	9.5	34	43.5	14.75
36	50	4.5	5.06	40.25	39.38	9.88	36	46	15
38	47.5	4.88	4.88	40.75	39.5	8.12	38	44	14.75
40	50	5.12	5.12	43	41.5	8.5	40	46.25	15.5
42	52	5.25	5.25	45	43.62	8.81	42	48.25	15.75
44	54.5	5.5	5.5	47.25	45.62	9.18	44	50.5	16.5
46	56.75	5.75	5.75	49.5	47.75	9.62	46	52.75	17
48	59.5	6	6	51.5	49.88	10.12	48	55.25	18
50	61.75	6.19	6.25	53.62	52	10.56	50	57.5	18.5
52	63.75	6.38	6.44	55.62	54	10.88	52	59.5	18.75
54	67	6.69	6.75	57.88	56.12	11.38	54	62.25	20
56	69	6.88	6.94	60.12	58.25	11.75	56	64.25	20.25
58	71	7	7.12	62.12	60.25	12.06	58	66.25	20.5
60	74.25	7.31	7.44	64.38	62.38	12.56	60	69	21.75

## MSS SP 44 CLASS 400 FLANGES INDUSTRIES AND APPLICATIONS WIDELY USED IN THE INDUSTRIES

- Pumps, Valves, and vessels in manufacturing and food processing.
- Pipe connections in industrial waterworks.
- Heat exchangers and heating systems of all sizes.
- Mining support.
- Nuclear power systems.
- Plumbing and mechanical systems.
- Assemblies in the oil, gas, and petrochemical industries.
- Fire protection systems.