

MSS SP 44 Class 300 Flanges Dimensions

MSS SP 44 CLASS 300 FLANGES DIMENSIONS

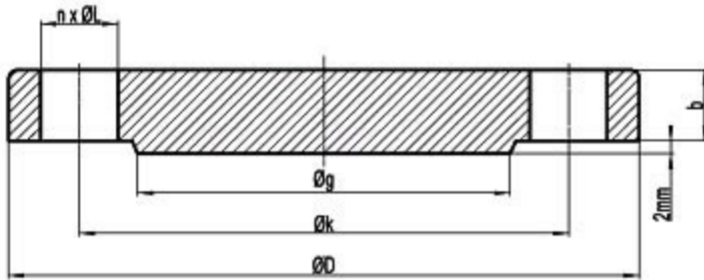

Series A Class 300 Flanges Dimensions										
Normal Size	Outside Daimeter	Thick.		Outside Daimeter of RF	Diameter at Base	Bore	LTH	Drilling		
		WN	BLRF					Dia Bevel	Circle Of Bolt	Length Of Bolt
O	C	C	R	X	B	Y	A	(1)	(2)	
26	38.25	3.07	3.25	29.5	28.38	—	7.19	26	34.5	10.75
28	40.75	3.32	3.5	31.5	30.5		7.69	28	37	11.25
30	43	3.57	3.69	33.75	32.56		8.19	30	39.25	12
32	45.25	3.82	3.88	36	34.69		8.69	32	41.5	12.5
34	47.5	3.94	4.07	38	36.88		9.07	34	43.5	13
36	50	4.07	4.32	40.25	39		9.44	36	46	13.5

38	46	4.19	4.19	40.5	39.12
40	48.75	4.44	4.44	42.75	41.25
42	50.75	4.63	4.63	44.75	43.25
44	53.25	4.82	4.82	47	45.25
46	55.75	5	5	49	47.38
48	57.75	5.19	5.19	51.25	49.38
50	60.25	5.44	5.44	53.5	51.38
52	62.25	5.63	5.63	55.5	53.38
54	65.25	5.94	5.94	57.75	55.5
56	67.25	6	6	59.75	57.62
58	69.25	6.19	6.19	62	59.62
60	71.25	6.38	6.38	64	61.62

7.06	38	43	12.5
7.56	40	45.5	13.25
7.82	42	47.5	13.75
8.06	44	49.75	14.25
8.44	46	52	15
8.75	48	54	15.25
9.07	50	56.25	16
9.32	52	58.25	16.5
9.88	54	61	17.5
10.19	56	63	17.75
10.44	58	65	18
10.69	60	67	18.5

Privacy - Terms

MSS SP 44 CLASS 300 FLANGES INDUSTRIES AND APPLICATIONS
WIDELY USED IN THE INDUSTRIES

- Pumps, Valves, and vessels in manufacturing and food processing.
- Pipe connections in industrial waterworks.
- Heat exchangers and heating systems of all sizes.
- Mining support.
- Nuclear power systems.
- Plumbing and mechanical systems.
- Assemblies in the oil, gas, and petrochemical industries.
- Fire protection systems.