

## DIN 2576 PN10 Plate Flange

DIN 2576 PN10 PLATE FLANGE DIMENSIONS, TECHNICAL DRAWINGS, AND APPROX. FLANGE WEIGHT

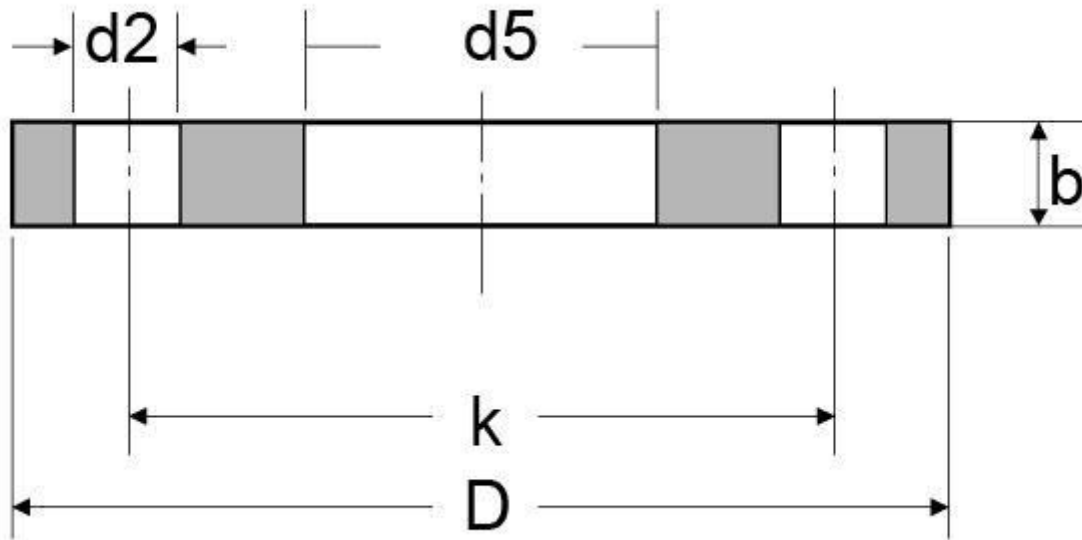

DIN 2576 PN10 PLATE FLANGE DIMENSIONS  
DIMENSIONS AND APPROX. FLANGE WEIGHT

Nominal Pipe Size	Diameter of Pipe		Flange Dimension			Nuts & Bolts			Approx. Flange Weight
			Flange I.D	Flange Dia	Thk of Flange	Dia of Bolt Circle	No. of Holes	Dia of Bolt Holes	
DN	ISO	DIN	d5	D	b	k		d2	KG /PCS
10	–	14	14.5	90	14	60	4	14	0.61
	17.2	–	17.7	90	14	60	4	14	0.6

15	–	20	21	95	14	65	4	14	0.67
	21.3	–	22	95	14	65	4	14	0.67
20	–	25	26	105	16	75	4	14	0.94
	26.9	–	27.6	105	16	75	4	14	0.94
25	–	30	31	115	16	85	4	14	1.13
	33.7	–	34.4	115	16	85	4	14	1.11
32	–	38	39	140	16	100	4	18	1.66
	42.4	–	43.1	140	16	100	4	18	1.62
40	–	44.5	45.5	150	16	110	4	18	1.89
	48.3	–	49	150	16	110	4	18	1.85
50	–	57	58.1	165	18	125	4	18	2.5
	60.3	–	61.1	165	18	125	4	18	2.46
65	76.1	–	77.1	185	18	145	4	18	2.99
80	88.9	–	90.3	200	20	160	8	18	3.61
100	–	108	109.6	220	20	180	8	18	4.17
	114.3	–	115.9	220	20	180	8	18	3.99
125	–	133	134.8	250	22	210	8	18	5.66
	139.7	–	141.6	250	22	210	8	18	5.41
150	–	159	161.1	285	22	240	8	22	6.97
	168.3	–	170.5	285	22	240	8	22	6.55
175	193.7	–	196.1	315	24	270	8	22	8.42
200	219.1	–	221.8	340	24	295	8	22	9.28
250	–	267	270.2	395	26	350	12	22	12.36
	273	–	276.2	395	26	350	12	22	11.85
300	323.9	–	327.6	445	26	400	12	22	13.61
350	355.6	–	359.7	505	28	460	16	22	20.35
	–	368	372.2	505	28	460	16	22	18.77
400	406.4	–	411	565	32	515	18	26	27.52
	–	419	423.7	565	32	515	18	26	35.43
450	457	–	462.3	615	38	565	20	26	35.11
500	508	–	613.6	670	38	620	20	26	40.2
600	610	–	615.5	780	40	725	20	26	51.87

## DIN 2576 PN10 PLATE FLANGE INDUSTRIES AND APPLICATIONS

### WIDELY USED IN THE INDUSTRIES

- Pumps, Valves, and vessels in manufacturing and food processing.
- Pipe connections in industrial waterworks.
- Heat exchangers and heating systems of all sizes.
- Mining support.
- Nuclear power systems.
- Plumbing and mechanical systems.
- Assemblies in the oil, gas, and petrochemical industries.

marcelforged.com