

DIN 2503 PN40 Flat Flange

DIN 2503 PN40 PLATE FLANGE DIMENSIONS, TECHNICAL DRAWINGS, AND APPROX. FLANGE WEIGHT

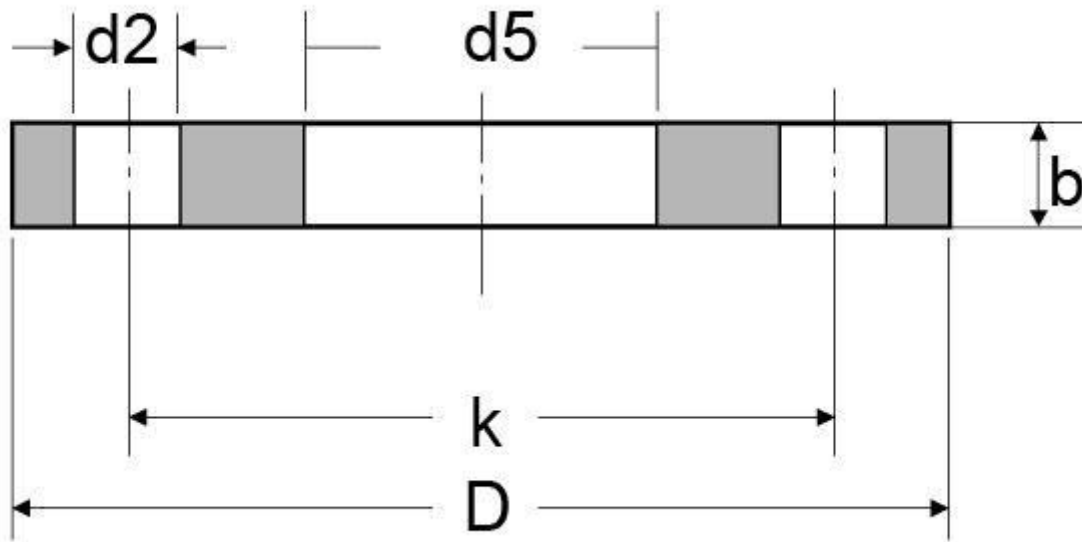

DIN 2503 PN40 PLATE FLANGE DIMENSIONS
DIMENSIONS AND APPROX. FLANGE WEIGHT

| Nominal Pipe Size | Diameter of Pipe | | Flange I.D | No. of holes | Flange Dia | Thk of Flange | Dia of Bolt Circle | Dia of Bolt Holes | Approx.Weight |
|-------------------|------------------|-----|------------|--------------|------------|---------------|--------------------|-------------------|---------------|
| | ISO | DIN | | | | | | | |
| DN | ISO | DIN | D5 | BN | D | b | K | d2 | KG/PCS |
| 10 | – | 14 | 14.5 | 4 | 90 | 16 | 60 | 14 | 0.7 |
| | 17.2 | – | 17.7 | 4 | 90 | 16 | 60 | 14 | 0.69 |
| 15 | – | 20 | 21 | 4 | 95 | 16 | 65 | 14 | 0.77 |

| | | | | | | | | | |
|------|-------|------|-------|----|------|----|------|----|--------|
| | 21.3 | – | 22 | 4 | 95 | 16 | 65 | 14 | 0.77 |
| 20 | – | 25 | 26 | 4 | 105 | 18 | 75 | 14 | 1.06 |
| | 26.9 | – | 27.6 | 4 | 105 | 18 | 75 | 14 | 1.05 |
| 25 | – | 30 | 31 | 4 | 115 | 18 | 85 | 14 | 1.27 |
| | 33.7 | – | 34.4 | 4 | 115 | 18 | 85 | 14 | 1.25 |
| 32 | – | 38 | 39 | 4 | 140 | 18 | 100 | 18 | 1.86 |
| | 42.4 | – | 43.1 | 4 | 140 | 18 | 100 | 18 | 1.83 |
| 40 | – | 44.5 | 45.5 | 4 | 150 | 18 | 110 | 18 | 2.12 |
| | 48.3 | – | 49 | 4 | 150 | 18 | 110 | 18 | 2.09 |
| 50 | – | 57 | 58.1 | 4 | 165 | 20 | 125 | 18 | 2.78 |
| | 60.3 | – | 61.1 | 4 | 165 | 20 | 125 | 18 | 2.74 |
| 65 | 76.1 | – | 77.1 | 8 | 185 | 22 | 145 | 18 | 3.48 |
| 80 | 88.9 | – | 90.3 | 8 | 200 | 24 | 160 | 18 | 4.33 |
| 100 | – | 108 | 109.6 | 8 | 235 | 24 | 190 | 22 | 5.82 |
| | 114.3 | – | 115.9 | 8 | 235 | 24 | 190 | 22 | 5.61 |
| 125 | – | 133 | 134.8 | 8 | 270 | 26 | 220 | 26 | 7.91 |
| | 139.7 | – | 141.6 | 8 | 270 | 26 | 220 | 26 | 7.6 |
| 150 | – | 159 | 161.1 | 8 | 300 | 28 | 250 | 26 | 10.12 |
| | 168.3 | – | 170.5 | 8 | 300 | 28 | 250 | 26 | 9.58 |
| 175 | 193.7 | – | 196.1 | 12 | 350 | 32 | 295 | 30 | 14.45 |
| 200 | 219.1 | – | 221.8 | 12 | 375 | 34 | 320 | 30 | 16.9 |
| 250 | – | 267 | 270.2 | 12 | 450 | 38 | 385 | 33 | 27.28 |
| | 273 | – | 276.2 | 12 | 450 | 38 | 385 | 33 | 26.51 |
| 300 | 323.9 | – | 327.6 | 16 | 515 | 42 | 450 | 33 | 36.38 |
| 350 | 355.6 | – | 359.7 | 16 | 580 | 46 | 510 | 36 | 52.83 |
| | – | 368 | 372.2 | 16 | 580 | 46 | 510 | 36 | 50.24 |
| 400 | 406.4 | – | 411 | 16 | 660 | 50 | 585 | 39 | 74.71 |
| | – | 419 | 423.7 | 16 | 660 | 50 | 585 | 39 | 71.44 |
| 500 | 508 | – | 513.6 | 20 | 755 | 52 | 670 | 42 | 86.87 |
| 600 | 610 | – | 616.5 | 20 | 890 | 54 | 795 | 48 | 121.84 |
| 700 | 711 | – | 716 | 24 | 995 | 58 | 900 | 48 | 150.93 |
| 800 | 813 | – | 818 | 24 | 1140 | 64 | 1030 | 56 | 219.08 |
| 900 | 914 | – | 920 | 28 | 1250 | 70 | 1140 | 56 | 271.16 |
| 1000 | 1016 | – | 1022 | 28 | 1360 | 78 | 1250 | 56 | 344.95 |

DIN 2503 PN40 PLATE FLANGE INDUSTRIES AND APPLICATIONS

WIDELY USED IN THE INDUSTRIES

- Pumps, Valves, and vessels in manufacturing and food processing.
- Pipe connections in industrial waterworks.
- Heat exchangers and heating systems of all sizes.
- Mining support.
- Nuclear power systems.
- Plumbing and mechanical systems.
- Assemblies in the oil, gas, and petrochemical industries.
- Fire protection systems.

marcelforged.com