

ASME B16.5 Class 900 Flanges

ASME B16.5 CLASS 900 RTJ FACING FLANGES DIMENSIONS AND TECHNICAL DRAWINGS

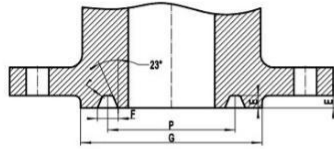

Figure-1: the ASME B16.5 flange with a ring-type joint (RTJ) facing. P – pitch diameter of groove; G – minimum diameter of raised portion; F – upper width of groove; r – radius at bottom of groove; E – depth of groove, equal to height of raised portion; 23°: slope angle of side wall.

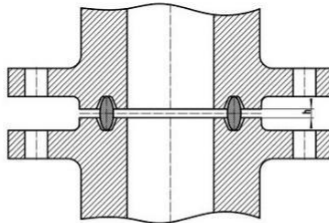

Figure-2: a RTJ joint consisting of two RTJ flanges and a metallic ring gasket which rests in the ring-joint groove. h: approximate distance between flanges. N: groove number.

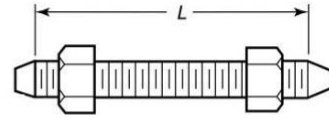

Figure-3: The stud bolt with two nuts for the connection of two RTJ flanges. Its length is denoted as L (L does not include the height of the points).

900# B16.5 FLANGES DIMENSIONS

RTJ FACING DIMENSIONS IN MM

| NPS | Groove No. | P | E | F |
|-------|------------|--------|------|-------|
| 1/2 | 12 | 39.67 | 6.35 | 8.74 |
| 3/4 | 14 | 44.45 | 6.35 | 8.74 |
| 1 | 16 | 50.80 | 6.35 | 8.74 |
| 1-1/4 | 18 | 60.33 | 6.35 | 8.74 |
| 1-1/2 | 20 | 68.27 | 6.35 | 8.74 |
| 2 | 24 | 95.25 | 7.92 | 11.91 |
| 2-1/2 | 27 | 107.95 | 7.92 | 11.91 |
| 3 | 31 | 123.83 | 7.92 | 11.91 |
| 4 | 37 | 149.23 | 7.92 | 11.91 |

| NPS | Groove No. | P | E | F |
|-----|------------|--------|-------|-------|
| 5 | 41 | 180.98 | 7.92 | 11.91 |
| 6 | 45 | 211.12 | 7.92 | 11.91 |
| 8 | 49 | 269.88 | 7.92 | 11.91 |
| 10 | 53 | 323.85 | 7.92 | 11.91 |
| 12 | 57 | 381.00 | 7.92 | 11.91 |
| 14 | 62 | 419.10 | 11.13 | 16.66 |
| 16 | 66 | 469.90 | 11.13 | 16.66 |
| 18 | 70 | 533.40 | 12.70 | 19.84 |
| 20 | 74 | 584.20 | 12.70 | 19.84 |
| 24 | 78 | 692.15 | 15.88 | 26.97 |

| NPS | r | G | h | L |
|-------|-----|------|---|-----|
| 1/2 | 0.8 | 60.5 | 4 | 110 |
| 3/4 | 0.8 | 66.5 | 4 | 115 |
| 1 | 0.8 | 71.5 | 4 | 125 |
| 1-1/4 | 0.8 | 81.0 | 4 | 125 |
| 1-1/2 | 0.8 | 92.0 | 4 | 140 |
| 2 | 0.8 | 124 | 3 | 145 |
| 2-1/2 | 0.8 | 137 | 3 | 160 |
| 3 | 0.8 | 156 | 4 | 145 |
| 4 | 0.8 | 181 | 4 | 170 |
| 5 | 0.8 | 216 | 4 | 190 |
| 6 | 0.8 | 241 | 4 | 195 |
| 8 | 0.8 | 308 | 4 | 220 |
| 10 | 0.8 | 362 | 4 | 235 |
| 12 | 0.8 | 419 | 4 | 255 |
| 14 | 1.5 | 467 | 4 | 280 |
| 16 | 1.5 | 524 | 4 | 290 |
| 18 | 1.5 | 594 | 5 | 335 |
| 20 | 1.5 | 648 | 5 | 360 |
| 24 | 2.4 | 772 | 6 | 455 |

ASME B16.5 CLASS 900 FLANGES INDUSTRIES AND APPLICATION

WIDELY USED IN THE INDUSTRIES

- Pumps, Valves, and vessels in manufacturing and food processing.
- Pipe connections in industrial waterworks.
- Heat exchangers and heating systems of all sizes.
- Mining support.
- Nuclear power systems.
- Plumbing and mechanical systems.
- Assemblies in the oil, gas, and petrochemical industries.
- Fire protection systems.

marcelforged.com