

ASME B16.5 Class 150 Flanges

ASME B16.5 CLASS 150 RTJ FACING FLANGES DIMENSIONS AND TECHNICAL DRAWINGS

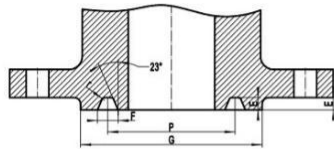

Figure-1: the ASME B16.5 flange with a ring-type joint (RTJ) facing. P – pitch diameter of groove; G – minimum diameter of raised portion; F – upper width of groove; r – radius at bottom of groove; E – depth of groove, equal to height of raised portion; 23°: slope angle of side wall.

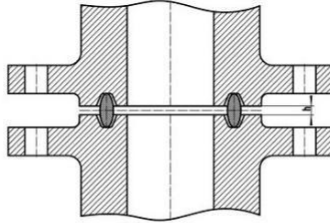

Figure-2: a RTJ joint consisting of two RTJ flanges and a metallic ring gasket which rests in the ring-joint groove. h: approximate distance between flanges. N: groove number.

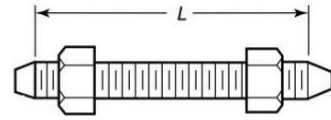

Figure-3: The stud bolt with two nuts for the connection of two RTJ flanges. Its length is denoted as L (L does not include the height of the points).

150# B16.5 FLANGES DIMENSIONS

RTJ FACING DIMENSIONS IN MM

NPS	N	P	E	F
1	15	47.63	6.35	8.74
1-1/4	17	57.15	6.35	8.74
1-1/2	19	65.07	6.35	8.74
2	22	82.55	6.35	8.74
2-1/2	25	101.60	6.35	8.74
3	29	114.30	6.35	8.74
3-1/2	33	131.78	6.35	8.74
4	36	149.23	6.35	8.74
5	40	171.45	6.35	8.74

NPS	N	P	E	F
6	43	193.68	6.35	8.74
8	48	247.65	6.35	8.74
10	52	304.80	6.35	8.74
12	56	381.00	6.35	8.74
14	59	396.88	6.35	8.74
16	64	454.03	6.35	8.74
18	68	517.53	6.35	8.74
20	72	558.80	6.35	8.74
22	80	615.95	6.35	8.74
24	76	673.10	6.35	8.74

NPS	r	G	h	L
1	0.8	63.5	4	75
1-1/4	0.8	73.0	4	85
1-1/2	0.8	82.5	4	85
2	0.8	102	4	95
2-1/2	0.8	121	4	100
3	0.8	133	4	100
3-1/2	0.8	154	4	100
4	0.8	171	4	100
5	0.8	194	4	110
6	0.8	219	4	115
8	0.8	273	4	120
10	0.8	330	4	125
12	0.8	406	4	135
14	0.8	425	3	145
16	0.8	483	3	145
18	0.8	546	3	160
20	0.8	597	3	170
22	0.8	648	3	185
24	0.8	711	3	185