

## ASME B16.47 Series B Class 900 Flange Dimensions

### ASME B16.47 SERIES B CLASS 900 FLANGE DIMENSIONS

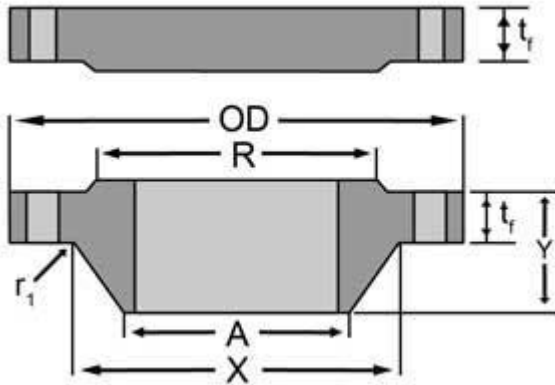

Nominal Size	Outside Diameter (OD)	Min. Thickness [Note1] – WNF (tf)	Min. Thickness [Note1] – Blind (tf)	Length Through Hub (Y)	Hub Dia. Base [Note2] (X)	Hub Dia. Top (A)	Raised Face Dia. (R)	Drilling – Bolt Circle Dia.	Dri – N Bo Ho
26	40.25	5.31	6.06	10.19	29.25	26.00	30.00	35.50	20
28	43.50	5.81	6.56	10.88	31.38	28.00	32.25	38.25	20
30	46.50	6.12	6.93	11.38	33.50	30.00	34.50	40.75	20
32	48.75	6.31	7.31	11.94	35.75	32.00	36.50	43.00	20
34	51.75	6.75	7.68	12.56	37.88	34.00	39.00	45.50	20
36	53.00	6.81	7.94	12.81	40.00	36.00	40.50	47.25	24
38	57.50	7.50	8.50	13.88	42.25	38.00	43.25	50.75	20
40	59.50	7.75	8.81	14.31	44.38	40.00	45.75	52.75	24
42	61.50	8.12	9.12	14.62	46.31	42.00	47.75	54.75	24
44	64.88	8.44	9.56	15.38	48.62	44.00	50.00	57.62	24

46	68.25	8.88	10.06	16.18	50.88	46.00	52.50	60.50	24
48	70.25	9.19	10.38	16.50	52.88	48.00	54.50	62.50	24

◀ ▶

## ASME B16.47 SERIES B CLASS 900 FLANGE INDUSTRIES AND APPLICATIONS WIDELY USED IN THE INDUSTRIES

- Pumps, Valves, and vessels in manufacturing and food processing.
- Pipe connections in industrial waterworks.
- Heat exchangers and heating systems of all sizes.
- Mining support.
- Nuclear power systems.
- Plumbing and mechanical systems.
- Assemblies in the oil, gas, and petrochemical industries.
- Fire protection systems.

marcelforged.com