

ASME B16.47 Series B Class 75 Flange Dimensions

ASME B16.47 SERIES B CLASS 75 FLANGE DIMENSIONS

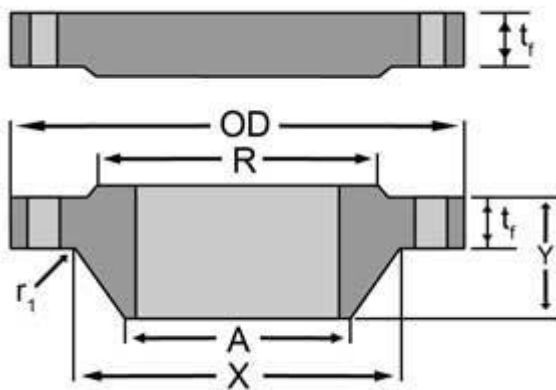

Nominal Size	Outside Diameter (OD)	Min. Thickness [Note1] – WNF (tf)	Min. Thickness [Note1] – Blind (tf)	Length Through Hub (Y)	Hub Dia. Base [Note2] (X)	Hub Dia. Top (A)	Raised Face Dia. (R)	Drilling – Bolt Circle Dia.	Drilling – Bolt Hole
26	30.00	1.25	1.25	2.25	26.62	26.06	27.75	28.50	36
28	32.00	1.25	1.25	2.38	28.62	28.06	29.75	30.50	40
30	34.00	1.25	1.25	2.50	30.62	30.06	31.75	32.50	44
32	36.00	1.32	1.38	2.69	32.62	32.06	33.75	34.50	48
34	38.00	1.32	1.44	2.82	34.62	34.06	35.75	36.50	52
36	40.69	1.38	1.61	3.32	36.81	36.06	38.00	39.06	40
38	42.69	1.44	1.69	3.44	38.81	38.06	40.00	41.06	40
40	44.69	1.44	1.69	3.57	40.81	40.06	42.00	43.06	44
42	46.69	1.50	1.82	3.69	42.81	42.06	44.00	45.06	48

44	49.25	1.63	1.88	4.07	44.88	44.06	46.25	47.38	36
46	51.25	1.69	1.94	4.19	46.88	46.06	48.25	49.38	40
48	53.25	1.75	2.07	4.32	48.88	48.06	50.25	51.38	44
50	55.25	1.82	2.13	4.50	50.94	50.06	52.25	53.38	44
52	57.38	1.82	2.19	4.69	52.94	52.06	54.25	55.50	48
54	59.38	1.88	2.32	4.88	55.00	54.06	56.25	57.50	48
56	62.00	1.94	2.38	5.25	57.12	56.06	58.50	59.88	40
58	64.00	2.00	2.44	5.38	59.12	58.06	60.50	61.88	44
60	66.00	2.13	2.57	5.63	61.12	60.06	62.50	63.88	44

ASME B16.47 SERIES B CLASS 75 FLANGE INDUSTRIES AND APPLICATIONS

WIDELY USED IN THE INDUSTRIES

- ▮ Pumps, Valves, and vessels in manufacturing and food processing.
- ▮ Pipe connections in industrial waterworks.
- ▮ Heat exchangers and heating systems of all sizes.
- ▮ Mining support.
- ▮ Nuclear power systems.
- ▮ Plumbing and mechanical systems.
- ▮ Assemblies in the oil, gas, and petrochemical industries.
- ▮ Fire protection systems.