

## ASME B16.47 Series B Class 600 Flange Dimensions

### ASME B16.47 SERIES B CLASS 600 FLANGE DIMENSIONS

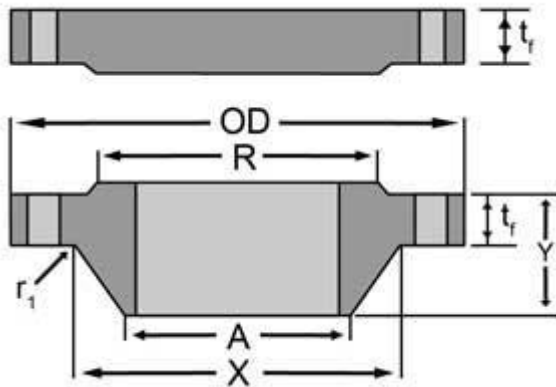

Nominal Size	Outside Diameter (OD)	Min. Thickness [Note1] – WNF (tf)	Min. Thickness [Note1] – Blind (tf)	Length Through Hub (Y)	Hub Dia. Base [Note2] (X)	Hub Dia. Top (A)	Raised Face Dia. (R)	Drilling – Bolt Circle Dia.	Drilling – N Bo Ho
26	35.00	4.38	4.38	7.12	27.50	26.00	28.62	31.75	28
28	37.50	4.56	4.56	7.50	29.62	28.00	30.88	34.00	28
30	40.25	4.94	5.00	8.06	31.75	30.00	33.12	36.50	28
32	42.75	5.12	5.31	8.50	33.88	32.00	35.25	38.75	28
34	45.75	5.56	5.68	9.19	36.00	34.00	37.50	41.50	24
36	47.75	5.75	5.94	9.56	38.12	36.00	39.75	43.50	28
38	50.00	6.00	6.12	10.00	40.25	38.00	41.50	45.75	28
40	52.00	6.25	6.38	10.38	42.25	40.00	43.75	47.75	32
42	55.25	6.62	6.75	11.00	44.38	42.00	46.00	50.50	28

44	57.25	6.81	7.00	11.38	46.50	44.00	48.25	52.50	32
46	59.50	7.06	7.31	11.81	48.62	46.00	50.25	54.75	32
48	62.75	7.44	7.69	12.44	50.75	48.00	52.25	57.50	32
50	65.75	7.75	8.00	12.94	52.88	50.00	54.50	60.00	28
52	67.75	8.00	8.25	13.25	54.88	52.00	56.50	62.00	32
54	70.00	8.25	8.56	13.75	57.00	54.00	58.75	64.25	32
56	73.00	8.56	8.88	14.25	59.12	56.00	60.75	66.75	32
58	75.00	8.75	9.12	14.56	61.12	58.00	63.00	68.75	32
60	78.50	9.19	9.56	15.31	63.38	60.00	65.25	71.75	28

**ASME B16.47 SERIES B CLASS 600 FLANGE INDUSTRIES AND APPLICATIONS  
WIDELY USED IN THE INDUSTRIES**

- Pumps, Valves, and vessels in manufacturing and food processing.
- Pipe connections in industrial waterworks.
- Heat exchangers and heating systems of all sizes.
- Mining support.
- Nuclear power systems.
- Plumbing and mechanical systems.
- Assemblies in the oil, gas, and petrochemical industries.
- Fire protection systems.