

ASME B16.47 Series B Class 400 Flange Dimensions

ASME B16.47 SERIES B CLASS 400 FLANGE DIMENSIONS

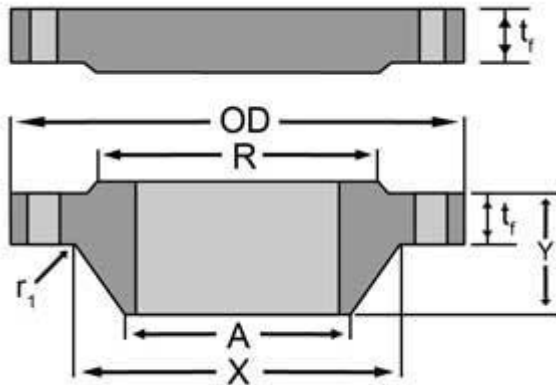

Nominal Size	Outside Diameter (OD)	Min. Thickness [Note1] – WNF (tf)	Min. Thickness [Note1] – Blind (tf)	Length Through Hub (Y)	Hub Dia. Base [Note2] (X)	Hub Dia. Top (A)	Raised Face Dia. (R)	Drilling – Bolt Circle Dia.	Drilling – N Bo Ho
26	33.50	3.50	3.50	5.88	27.12	26.00	28.00	30.75	28
28	36.00	3.75	3.75	6.25	29.12	28.00	30.00	33.00	24
30	38.25	4.00	4.00	6.69	31.25	30.00	32.25	35.25	28
32	40.75	4.25	4.25	7.06	33.25	32.00	34.38	37.50	28
34	42.75	4.38	4.38	7.38	35.38	34.00	36.50	39.50	32
36	45.50	4.69	4.69	7.88	37.50	36.00	38.62	42.00	28
38	47.50	4.88	4.88	8.12	39.50	38.00	40.75	44.00	32
40	50.00	5.12	5.12	8.50	41.50	40.00	43.00	46.25	32
42	52.00	5.25	5.25	8.81	43.62	42.00	45.00	48.25	32
44	54.50	5.50	5.50	9.18	45.62	44.00	47.25	50.50	32

46	56.75	5.75	5.75	9.62	47.75	46.00	49.50	52.75	36
48	59.50	6.00	6.00	10.12	49.88	48.00	51.50	55.25	28
50	61.75	6.19	6.25	10.56	52.00	50.00	53.62	57.50	32
52	63.75	6.38	6.44	10.88	54.00	52.00	55.62	59.50	32
54	67.00	6.69	6.75	11.38	56.12	54.00	57.88	62.25	28
56	69.00	6.88	6.94	11.75	58.25	56.00	60.12	64.25	32
58	71.00	7.00	7.12	12.06	60.25	58.00	62.12	66.25	32
60	74.25	7.31	7.44	12.56	62.38	60.00	64.38	69.00	32

ASME B16.47 SERIES B CLASS 400 FLANGE INDUSTRIES AND APPLICATIONS
WIDELY USED IN THE INDUSTRIES

- Pumps, Valves, and vessels in manufacturing and food processing.
- Pipe connections in industrial waterworks.
- Heat exchangers and heating systems of all sizes.
- Mining support.
- Nuclear power systems.
- Plumbing and mechanical systems.
- Assemblies in the oil, gas, and petrochemical industries.
- Fire protection systems.